

**J. Willburn Indian Allotment**

IA08 Map 4 T3S, R7E, S 11/12

See B07 for more on the Willburn extended family. See also HF01, HF04, and HF06.

The first letter of this name on the 1915 TNF map is somewhat illegible but appears to be a "J." There was no listing in the census records (see B05) for any member of the Willburn whose name began with the letter "T." The first letter could stand for James Willburn (Jr.) who would have qualified under the IA law. Further research will be needed to determine the ownership of this tract.

The tract is mapped based on the 1915 map that shows the tract as and IA.

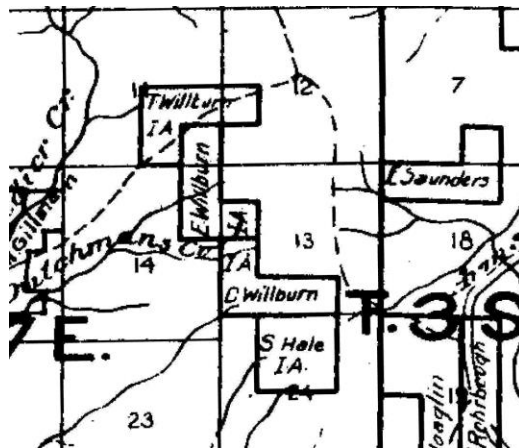

(A2: 28)

The 1907 TNF map shows it as private. This would indicate that it was patented under the IA law.

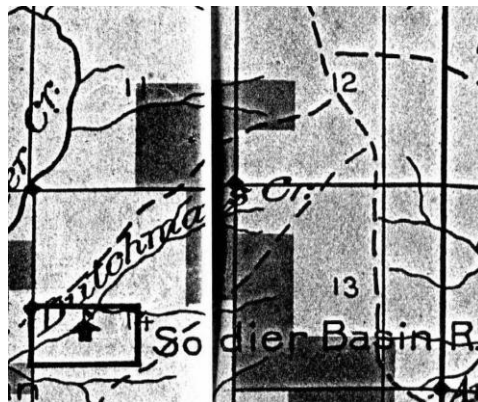

(A2: 06)

This tract still shows up as private on the SRNF 1977 map.