

E. Willburn Indian Allotment

IA07 Map 4 T3S, R7E, S 13/14

For information on the Willburn extended family see B05.

Given the problems with the initial GLO surveys, the tract is plotted on the Base Map based on the USGS map. This tract shows up on the 1915 map as an Indian Allotment under the name of E. Willburn.

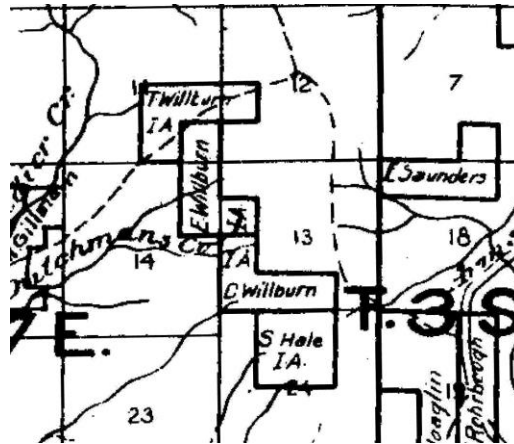

(A3: 28)

The tract also shows up on the 1907 TNF map as private. Therefore, it appears to have been patented under the IA.

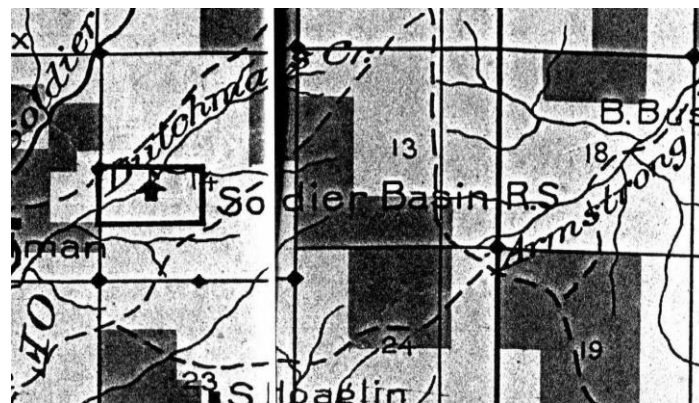

(A2: 06)

There is some confusion on how this tract was patented as it shows up on Lowden's 1894 map as being owned by a J. Wolverton.

IA07

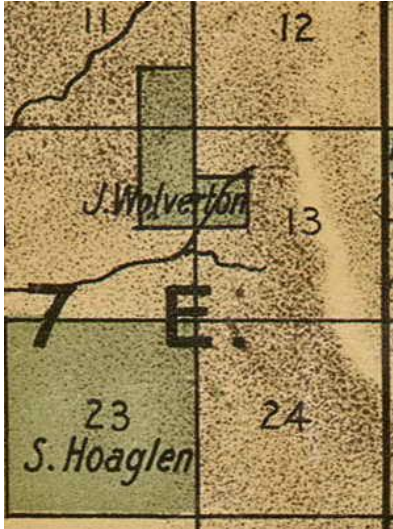

(A2: 05)

To make matters worse, there is no obvious member of the extended family (with Indian blood) with a surname beginning with the letter "E," except Aaron Willburn's (see HF02) daughter Emma who was born in 1894 and is listed as "Indian" on the 1900 census. She would have been eligible to file under the IA law. This would not be unusual, as noted elsewhere (see B05), it was not uncommon for extended families to try and "block up" several 160 acre tracts to increase the size of their ranch.

Further research will be needed to clarify who filed on this tract of land.

The tract still shows up as private on the SRNF 1977 map. Note how much the Section lines have changed in this area.

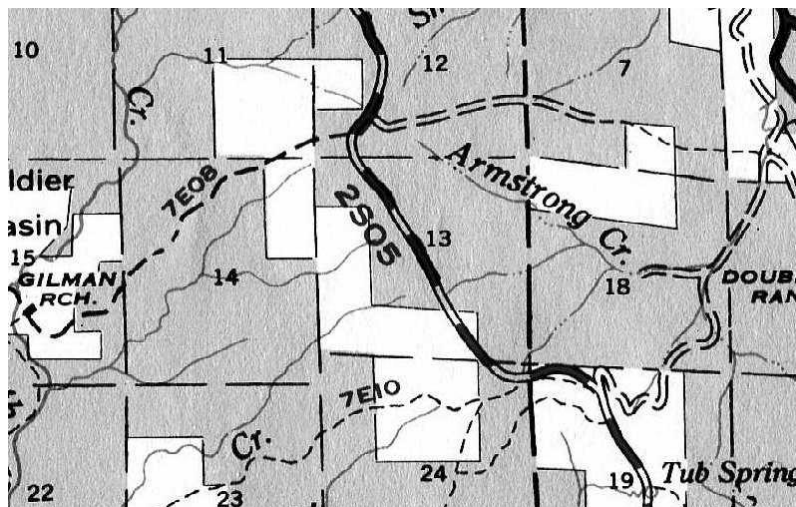

(A2: 21b)