

IA05 C. Willburn Indian Allotment

Map 4: T3S, R7E, S 13

The limited information on this tract of land is based on the 1915 TNF map that shows that it was acquired by "C Willburn" as an Indian Allotment--most likely under the Dawes General Allotment Act/Dawes Severalty Act 1887. Further research will be needed to confirm this. This tract does not appear on Lowden's 1894 map (A2: 05) but appears on 1907 TNF map as being private and that is before passage of the NF Indian Allotment Act of 1910.

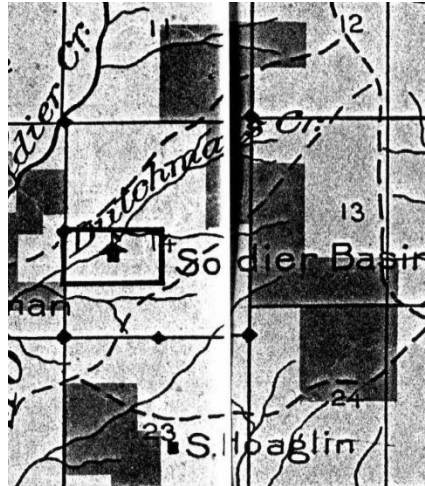

1907 TNF map.
(A2: 06)

C. Willburn is most likely Church Willburn. As noted in the section on the extended Willburn family (B05) on the 1880 census the children of James Willburn (Sr.) were listed as "white" but on the 1910 census they were listed as Indian (C. Willburn was not found on the Long Ridge 1900 census). The tract shows up on the 1915 TNF map as an Indian Allotment.

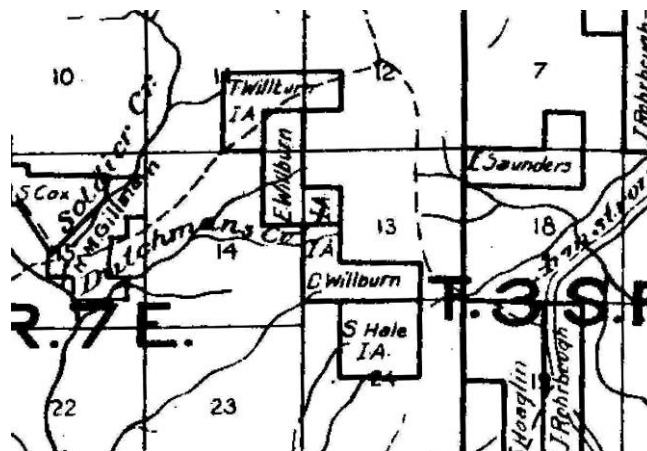

1915 TNF Map
(A2: 28)

IA05

There were no other references to any homestead being established at this location. The tract still shows up as private in the 1977 SFNR map.

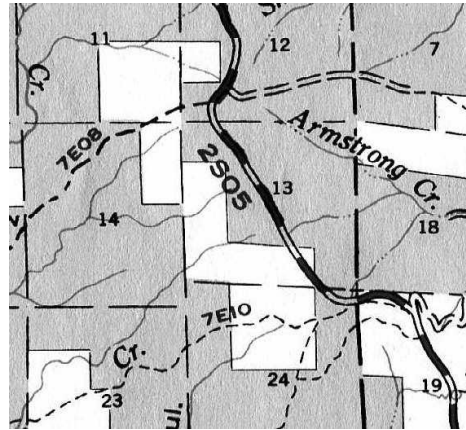

1977 SRNF map
(A2: 21b)