

## HA10

May Berry

HA10 Map 4: T4S, R8E, S.3

Refer to HA08 and HF12 for more information on Berry.

This tract shows up on the TNF 1915 map ("Berry" on the map). May Berry was the step-daughter of Augustus Russ (1/2 Indian) and daughter of Rose Russ (listed as black on the 1900 census)—see HA09 for more information on May Berry and the Russ family).

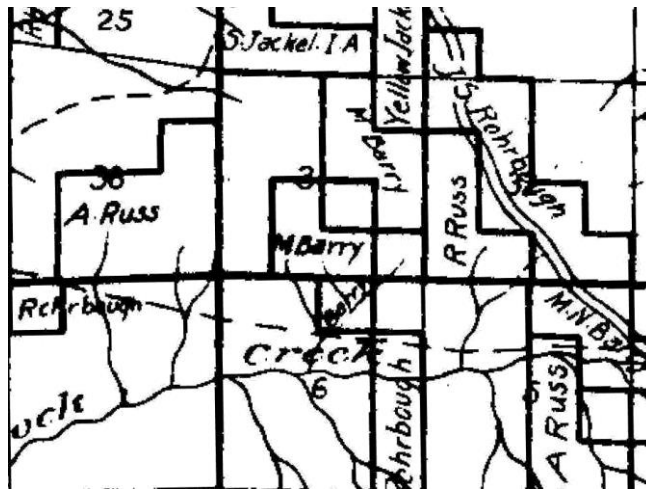

(A2: 28)

The tract is plotted on the Base Map as an HA as Berry is listed as "Black" on the 1900 census (see HF12). For that reason it is questionable if she would have qualified under the IA. That, however, remains unconfirmed.

The *Homestead Entry Report* completed by John T. Gray Feb. 9, 1911 for HF12 noted that "the claimant owned 160 acres of land at the time of filing and has since that time acquired an additional 160 acres, now owns 320 acres of range land." This would suggest that she was already in possession of this tract at the time she filed for entry on HF12.

There is no other information on this tract. It is plotted as such on the Base Map as an HA but with a dashed line to indicate that this is not definitive.

A search of the homestead files at SRNF may shed more light on this subject.