

## Church D. Willburn (Wilburn) Homestead

**HA05** Base Map 7: T5S. R8E, S 5, 8

H.E. #4471

There is a computer file and a hard copy file for this homestead entry.

The homestead is located on the east facing slope of Long Ridge near its southern end. The tract shows up on the 1909 TNF map.

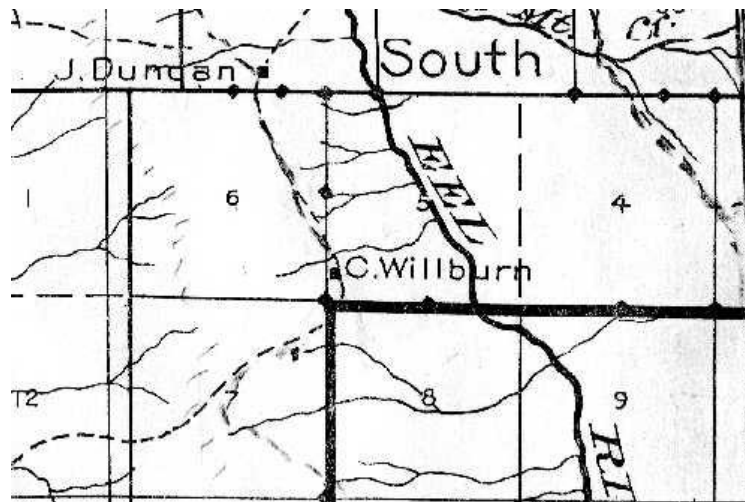

1909 TNF map showing the C. Willburn Place  
(A2: 08b)

Given the inaccuracy of the original 1870/1880 GLO surveys, plotting of this tract of land was problematic. It is mapped on the Base Map as set forth in the Homestead Entry record.

Church Willburn was the youngest son of James S. Willburn (Sr.) of Hettenshaw Valley and shows up on the 1880 census (A3: 1910-3) as "Churchman D. Willburn." For more on this subject see B05.

Willburn settled on the land in early July of 1901 and established residence (under the 1862 Homestead Act) on July 17, 1901 prior to establishment of TNF. After inspecting the homestead, the TNF MRRD Deputy Ranger John Gray wrote up his report on July 9, 1908 (HA05 Appendix). For that reason, it appears the parcel of land was grandfathered in under the 1862 Homestead Act. Some of the paper work is missing from the file to definitively determine if this is the case (see HA05 Appendix and hard copy file). Since it was inspected and the final patent was granted after the TNF was established, but Willburn declared entry in 1901, it has been plotted as being acquired under the Homestead Act of 1862 on the Base Map.

Gray's report notes that in 1908 Willburn was residing full time on the homestead with his wife and three children. They were living in a:

...frame house approx. 16 x 18 ft.: one large room is divided in three by loth partitions--siding split boards, roof covered with shakes, has floor 1 window and one door. Probable value \$45.00.

There was also a barn 18' x 52'--with 13' high walls, with a stable 12' wide on the east and west side of the barn.

The report noted that 75 acres was suitable for tilling but that no water was available for irrigation. 20 acres of land were "under the plow" and 45 acres were fenced. There was a hay field producing 15 to 20 tons of hay and vegetable garden. There was no substantial timber land on the parcel. Wilburn had used local timber to construct his improvements.

The form also asked (#16): *For what purpose is the land most valuable:* and Gray noted the land was: "Chiefly for grazing although nearly 1.2 the land is well suited for farming." Ranger Gray concluded his report stating that: "The claimant has fully complied with the homestead law. I recommend that patent be issued."

It is not clear when the patent was issued but there is a letter in the file (Appendix 1) indicating that final patent was to be issued to Willburn sometime later that year or the next.

Trail HTNF-07 connected the homestead to the west with Long Ridge (trail HTNF-12) and to the south and east with the Round Valley to Weaverville Trail (HTNF-11). Trail HTNF-43 just to the east of the ranch led north to the site of the Caution Post Office (location #3--moved from location #2 to location #3 in 1915).

### **Census data and the Spelling of Willburn vs. Wilburn**

The "Church Wilburn" family shows up on the census of 1910—refer to B05 for a complete discussion of the extended Willburn family. Just to make things more confusing, however, as shown below, some of the census years list the name "Willburn" and others Wilburn." this is even the case with official Forest Service correspondence (see Appendix 1). It appears that this error is spread across the historic documents on this area. As it stands there seems to be no standardized spelling. Also—the various census listings sometimes classify members of the Willburn family as "white" and sometimes as "Indian." Note that Bauer and Barney (1997) who know some family members personally used "Willburn" in their book.

49 92	Willburn Church	Head	M	71	35	M	5	California	Missouri	California
	Louise	Wife	F	71	25	M	5	California	Missouri	California
	Ester R.	Daughter	F	71	7	S		California	California	California
	Polly C.	Daughter	F	71	5	S		California	California	California
	Hazel L.	Daughter	F	71	3	S		California	California	California
	Belgie J.	Daughter	F	71	2	S		California	California	California

Note that Wilburn is spelled with only one "L" and that his father was born in Missouri and his race is race is "white."

(A3: 1910-6)

Willburn, Church H.	Head	M	71	W	45	M
" Louise F.	wife	F	71	W	35	M
" Esther R.	daughters	F	71	W	17	S
" Corrine	daughter	F	71	W	15	S
" Hazel L.	daughter	F	71	W	13	S
" Edna F.	daughter	F	71	W	8	S
" Marie R.	daughter	F	71	W	3	S

1920 census: Hazel L. "Willburn" (see P&P entry) is on this listing.

She passed away on January 11, 2006 see that entry for more information).

(A3: 1920-1)

Note that on the 1930 census the name is spelled "Wilburn" and it records his father as being born in Texas and that his race was listed as "Indian" as was the whole family

55 72	Wilburn, Church L.	Head	M	54	27	W	40	California	Texas
	Louise F.	wife	F	54	17	W	40	California	Missouri
	Hazel L.	Daughter	F	22		W	40	California	California
	Esther R.	Daughter	F	15		W	40	California	California
	Merle R.	Daughter	F	13		W	40	California	California
	Al W.	Son	M	11		W	40	California	California

1930 Census

On the 1940 census the "Wilburns" were again listed as "white" and were still living on Long Ridge.

520 750	Wilburn Church D.	Head	M	67	M	8	8
	Louise	wife	F	63	M	8	8
	Hazel	daughter	F	28	S	H4	30
	Petry	son	M	18	S	H3	20
	Calvin	son	M	16	S	H2	10
	Helen	daughter	F	11	S	H	8
	Marlin	daughter	F	9	S	H	4
	Gladys	daughter	F	19	S	H3	20

(A3: 1940-8)

The Church Willburns were not traced after 1940, at that time they were still living on the homestead. The Willburn family still owned this parcel and some members of the family were still living here in the 1980s.



HA05 Image  
Church and Lulu Willburn no date  
(Bauer and Barney 1997: 225)

**Appendix**  
**REPORT ON AGRICULTURAL SETTLEMENT**

Form 655

UNITED STATES DEPARTMENT OF AGRICULTURE  
FOREST SERVICE

**REPORT ON AGRICULTURAL SETTLEMENT.**

*Trinity*

Forest Reserve,

*Eureka*

Land District.

1. Location of settlement or farm: *SW 1/4, NW 1/4, N 1/2 SW 1/4, Sec. 5*  
*and NW 1/4, NW 1/4, Sec. 8, T. 5 S., R. 8 E., N.M.*  
(If land is surveyed, describe it by subdivisions; if unsurveyed, describe by streams or other natural landmarks, distances, and directions. Add a sketch map, if necessary.)

2. Name of present claimant or owner: *Church D. Hillburn*

Address of present claimant or owner: *Castroville Calif*

3. If claimant has a family, of what members does it consist? *Family consists of wife and 3 children, their only home is on this land.*  
(Is their only home on this claim?)

4. Is the land patented or held as a homestead or other entry, mining claim, or simply as a squatter location? Give number of entry: *HE # 220 4471*

5. Description of house, giving size, materials of which built, and number of rooms: *Frame House 946 16x18 ft. One large room divided in three by cloth partitions - Siding split boards, roof covered with shingles, has floor 1 window and one door. Probab Val. \$45.00*  
(What is its probable value?)

6. Description of barn and other outbuildings by size and materials: *18x52-12 1/2 ft. by 1/2 ft. frame. Stable 12 ft wide built on East and West sides of barn.*  
(What is their probable value?)

7. How much of the land is suited to tilling? *75 acres*

Acres of land under plow: *20 acres* Acres of land under fence: *45 acres*

Acres of land under ditch: *No water available for irrigation*

8-566

8. What does claimant raise on the land? Hay and gardens  
 How much was raised the past season? 15 or 20 ton of hay and garden  
for his own use.  
 What area has been cultivated, and in what years? 15 to 20 acres cultivated each year since 1901

9. Number of acres of timberland on the claim: No timberland  
 Estimated number of feet of timber in board measure: 120,000 ft. B.M.  
 How much, if any, timber has been cut? 70,000 ft. B.M.  
 For what purpose cut? for improvements  
 By whom cut? C.D. Millburn Date of cutting: timber cut each yr. since settlement 1901  
 If cut for cultivation, has the ground where the timber stood been cultivated, and how cultivated? No timber cut for cultivation  
 If cut for improvements, was the whole amount of timber cut put into improvements on the claim?  
All timber cut for improvements has been used on the land  
 Has claimant sold or negotiated for the sale of any timber? No,

10. Live stock owned by claimant:  
 Number of cattle: 4 Number of horses: 4  
 Number of sheep: — Number of goats: —  
 Where are they grazed? on the claim and public land adjoining  
 Has permit been obtained for them to graze on public land? Application has been made.

11. Date claimant settled on this land: In July 1901 exact date not known  
 Date claimant filed on this land: July 17, 1901  
 Date claimant established actual residence on this land: July 1901  
 State whether claimant has lived continuously on land, or only at certain times: Claimant has resided continuously on the land.  
 Give dates and duration of and reasons for absences, and report if family remained on land during such absences. Give source of information: Information received from Geo. Cane Canton Calif, and Chas L Bushnell, Post Office Rush Calif. and from claimant and his family



What evidences of residence, such as cultivation or presence of farming implements or household

furniture, were found by forest officers? *Plows, Harrow Etc. for farming, exist. Complete household outfit - stove, dishes, beds, bedding, Etc.*

12. Is the claim used in any way for trade or business? *Yes*

13. Ascertain, if possible, whether this claimant has ever made a homestead entry elsewhere; if so, state where, and whether it has been perfected or abandoned: \_\_\_\_\_

*First HE Made by the claimant.*

14. Has claim been sold or mortgaged? *No*

15. If this claim or entry is believed to have been made at the instance or in the interest of any others, or believed to be in any way fraudulent, give name, residence, and post-office address of reliable witnesses and abstract of their testimony: *I believe this claim to be O.K.*

16. For what purpose is the land most valuable? *Chiefly grazing - although nearly 1/2 of the land is well suited for farming.*

17. Date forest officer examined this claim: *July 8, 1908.*

18. Remarks: *The claimant has fully complied with the Homestead law has made it his actual home, has both cultivated and used the <sup>land</sup> for grazing purposes. Erected and good improvement fencing buildings, Etc. upon the land.*

19. Recommendation as to action that should be taken, and reasons for the recommendation: *Since the claimant has fully complied with the homestead law I recommend that Patent be issued*

Dated at *Butte Calif.* *July 9*, 190*8*

*J. T. Gray*  
Deputy Forest Ranger.

Approved \_\_\_\_\_, 190

Forest Supervisor.

UNITED STATES DEPARTMENT OF AGRICULTURE  
FOREST SERVICE

Trinity National Forest

Weaverville, California.

June 22, 1908.

Church D. Wilburn, H.E. 4471  
Eureka Land Dist.- Trinity

Mr. John T. Gray,  
Ruth, California.

Dear Gray:

Forms 655 are enclosed for an examination and report in the above case, covering the SW 1/4 of NW 1/4, W 1/2 of SW 1/4 Sec. 5 and the NW 1/4 NW 1/4 Section 8, T 5 S., R 8 E., H. M. Final Proof to be made at Eureka, July 31st. The witnesses named are Augustus Russ, Thomas D. Crabtree, Thomas G. Duncan and Hiram D. Wilburn of Caution, California. Please, if possible, make this report in time for us to make recommendation to the Local Land Office before date of Final Proof, otherwise we shall be obliged to ask for an extension of time.

Very truly yours,

*J. H. ...*  
Forest Supervisor.