

Hosea E. Myers (Herman)

HA04 Map 7: T26N, R5E S 31 (MDM)

Date of entry: June 20, 1905, filed under the Homestead Act of 1862; Homestead Entry 5356

There is a copy of the homestead entry record and some administrative letters concerning this tract in the hard copy file.

The relationship of the Meyers family living in the Kettenpom/Hoaglin Valley area is unclear. H. Meyers is not listed on the 1900 census; he and his family are, however, listed on the 1910 census. Information at the Caution School entry indicates that at some point during this time (about 1910 to about the end of the decade) Meyer's children were attending school so it is clear they were still living in the area at that time.

799	Myers Herman	Head	M 76 40 M2		
	Edgar Mary	Companion	F 45 M1	4	1
176	Lorrey Lizzie	step daughter	F 37 wd 1	7	5
	Paul	son	M 16 S		
	Pitney	son	M 8 S		
	Tine	son	M 4 S		
	George	son	M 2 S		
	Sadie	daughter	F 8 S		

1910 census listing the Meyers family.
(A3: 1910: 8)

The family does not show up on the 1920 census. It is not known when they left the area. The tract still shows up on the 1915 TNF map.



1915 TNF map.
(A2: 28)

HA04

Location

This tract was located about two miles to the southwest of Red Mountain House; above the north facing slope of Red Mountain Creek (Map 1). The tract shows up on the TNF 1907 and 1909 maps (Maps 1-2).

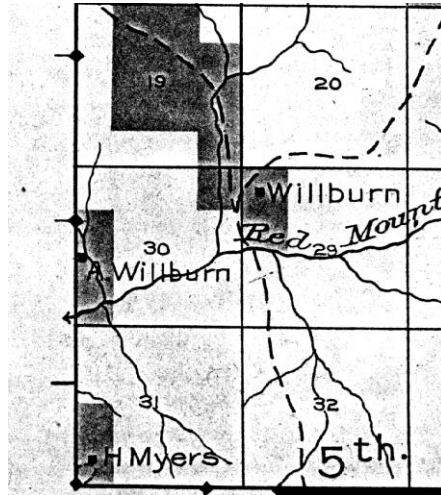

Map 1 1907 TNF map
(A2: 06)

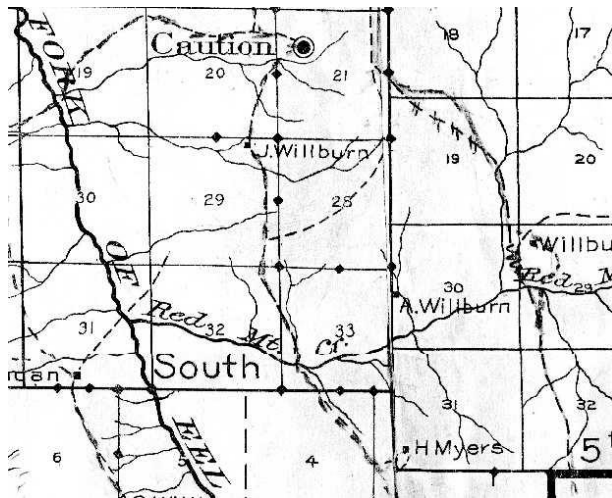

H. Myers cabin is shown in the lower right hand corner of map.
Map 2 TNF 1909 (A2: 08b)

Background

The only document available in the homestead file is TNF MRRD ranger John Gray's inspection of the homestead on April 12, 1912; prior the patent being issued (see the

HA04

computer and hard copy files). Hosea Myers and his family moved onto the parcel in 1903. When Gray inspected the homestead Myers wife and step daughter were living there. According to Gray's report, Myers filed entry on June 20, 1905. Thus, this parcel was most likely grandfathered in under the 1862 Homestead Act. The NFHA forms are not referenced in this homestead file further supporting this contention.

The following summary is taken from Gray's report (see HA04 Appendix). Some minor editing changes have been made for clarity.

Topography and Surface

Lot 8, Section 3 is mountainous land and has a general west exposure. Its slope is 10% or better. The land is semi-open, a scattered growth of Douglas fir, yellow pine, black oak and white oak timber occurring.

[Gray also describes lots 3, 4, and 5. He concluded that] ...As a whole the claim is too rough for extensive cultivation. If cleared of brush and timber it would hardly be possible to cultivate more than 30 acres.

Settlement and Residence

[Meyers] ...established actual residence on these lands during the summer of 1903 and has since that time maintained a continuous residence. His only absences being for from a few days to a few weeks during the summer months while working for wages on nearby ranches. During these short absences his wife remained on the land.

H.D. Willburn of Caution Calif. who has acted as Assistant Postmaster at this place since 1905 and who has lived in this neighborhood since the summer of 1903, states...that the claimant or his family have resided continuously on these lands and has annually cultivated some portion.

Arron Willburn and Wm. Axton both living near these lands, bear out the statements made by H. D. Willburn.

[Gray then writes]...I have been familiar with these lands during the past five years, passing the claim on the average of five times a year. From the observations taken at these times I am prepared to say that the claimant appears to have maintained a continuous residence on these lands and has annually cultivated a few acres. Found eight acres under cultivation. On the claim was noted a plow, harrow, axes, shovel, hoe, and other farm implements. In the dwelling was noted beds, bedding, stove, dishes, cooking utensils, table and various other household effects.

HA04

Improvements

Dwelling, a frame structure, approx. 12' x 30' shed roof, wall 12' and 8' made of split lumber nailed upright to girts with [battens] of same material. Roof is covered with split shakes, has four doors but no windows, has floor. Building is probably worth: \$100.00. A new house is under construction, the frame of which is now built and measures 15' x 30' walls 10' with a frame for porch 9' in width surrounding the main building. 4500 split shakes have been made and are now on the ground to be used in completing this structure. His dwelling is habitable,.

A log barn 14' x 20' walls 9' with a 12' shed on either side of building. Walls are not covered, roof is covered with split shakes. Probable value \$75.00.

Hog house 5' x 8' made of split lumber roofed with split shakes and surrounded by a rail pen 40' square is probably worth \$15.00

A wood shed approx. 10' x 12' walls 10' high, walls are not boarded up. Roofed with split shakes, is probably worth \$15.00. No other buildings noted. Two enclosures on the place, one containing approx. 8 acres and one containing 2 1/2 acres of land. The fencing is pickets and rails, 240 rods in all. Along the southern boundary of the claim is also found a fence 1/4 mile in length presumably a drift fence built by stockmen. This fence consists of posts and four slats or rails nailed to the posts. All the improvements were built by the present claimant. A good spring near the dwelling provides plenty of water for domestic use.

Cultivation

Seven to eight acres now producing agricultural crops. During the years 1904, 1905, 1906, four acres planted in corns grain for hay and garden for home use. During the years-1907, 1908, and 1909 five acres planted in corn, gardens and grain. During the years 1910 and 1911 seven and one half to eight acres under cultivation, 2 1/2 acres planted in corn and gardens with 5 to 5 1/2 acres sown in grain for hay'. Most every year from 1 to 4 tons of wild grass hay has been cut on the claim. All hay grown has been fed to stock on the claim. There is 12 bearing fruit trees five years old, apples, peaches and plums. 60 yearling trees not bearing fruit. A strawberry patch consists of 4 or 5 hundred plants and about 150 blackberry vines these are hearing fruit. There has been 6 acres slashed and the timber and brush burned. Three acres cleared and the land cultivated. Cost of clearing would probably be \$35.00 per acre, value after clearing would not exceed \$10.00 per acre. Two acres irrigated to some extent from a spring, no ditching required.

HA04

Grazing

The claimant owns 3 head of horses and 2 head of cattle also a few hogs. 1/2 doz. chickens and 3 turkeys. These stock graze on the claim at lease under Reg. G-2.

Timber

ON the claim there is about 60 acres of timberland, the remaining part of the claim is open and semi-open land....The claimant has sold not timber off the land.

Good Faith

The claim has the appearance of a permanent house. The buildings and other improvements are in good repair. There [are] gardens growing and grain crops have been harvested. The claimants are living on the land and there is household furniture on the claim necessary to make a home reasonably comfortable.

Recommendation

Since...Hosea H. Myers has lived on the land in good faith cultivated these lands for a period exceeding five years and I believe in other respects fully complied with the Homestead laws. I therefore, recommend that patent [be] issue[d].

Signed: John F. Gray
Forest Ranger

Ruth, California
April 19, 1912.

Although the homestead file does not contain the documentation related to the final date it is clear that the process was concluded and Meyers received patent sometime after April of 1912.

This parcel may have been part of the Brown Land Exchange (CRIR 05-10-47, Keter 1986, SRNF) or other archaeological survey projects in the area. Check coverage and site location maps in HR at SRNF.

HA04

HA04 Hosea Myers Homestead Plot Map

